

Installation Precautions:

1. Please read through the Instructions before installation.
2. This lamp is used on W track systems or tracks with compatibility with other company brands. It is equipped with rail parameters: input voltage: AC 220-240V 50/60Hz, maximum current: 16A, maximum load: 3680W;
3. The product should be installed by a professional electrician.
4. Make sure the power supply is cut off before installation and maintenance, to avoid the risk of electric shock.
5. Only suitable for indoor installation and use (not suitable for humid environments);
6. The light source of this lamp is no replaceable, and once it needs to be replaced (such as at the end of the lamp's lifespan), the entire lamp should be replaced;
7. Please keep this Instruction properly for future reference.

Warning: Do not touch fingers or other objects with the reflector's light outlet, otherwise it will affect the light output effect!

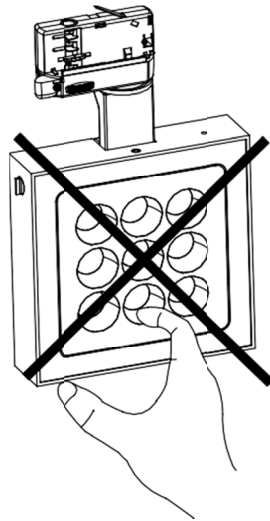

1. Assemble the rail light connector

- 1) Before assembly, ensure that the "conductive switch" is parallel to the connector, and display the "1", "2", or "3" status in the circle of the commutation knob as required.

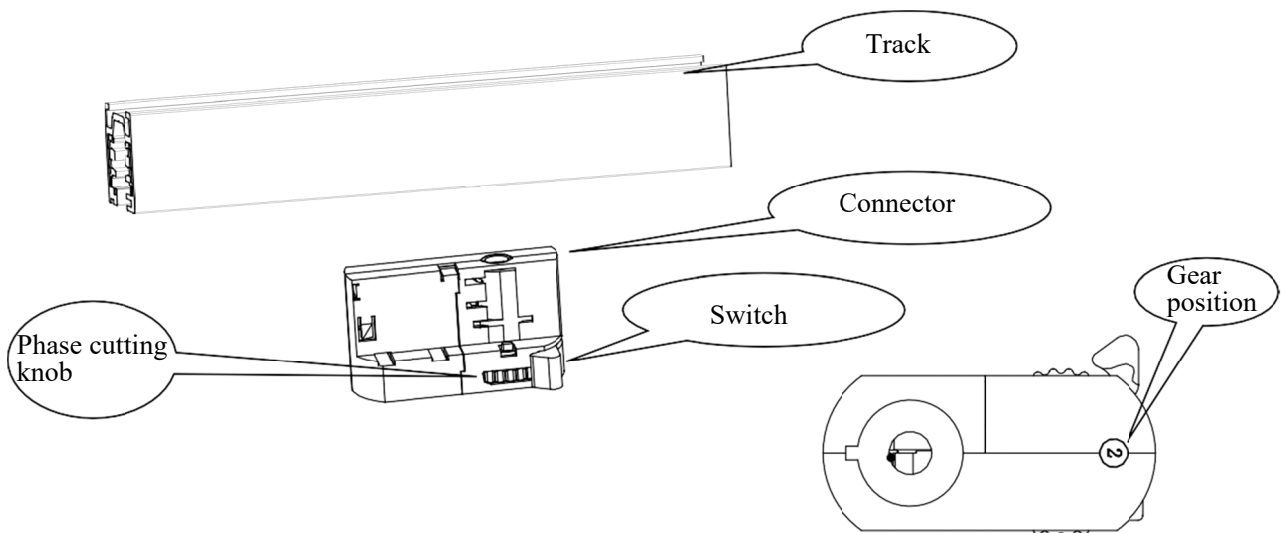

2) Align the protrusion of the guide rail light connector with the groove of the guide rail before assembly.

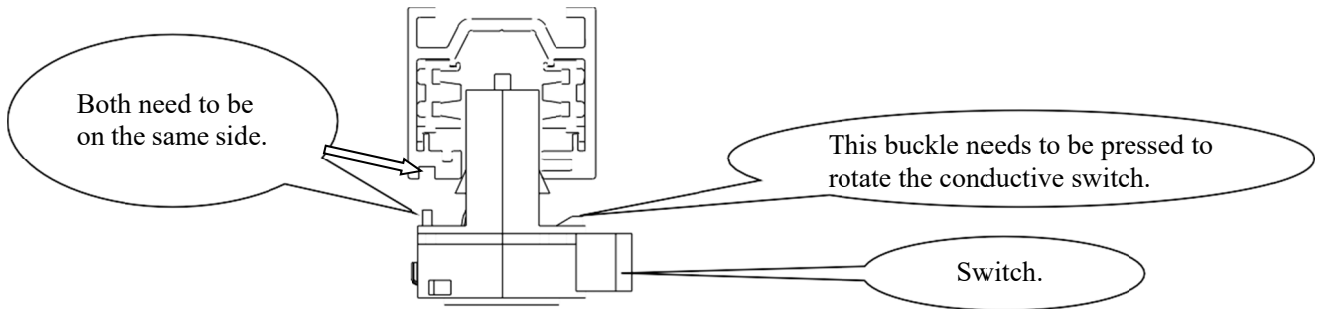

3) After assembly, rotate the "conductive switch" clockwise by 90 degrees to conduct electricity.

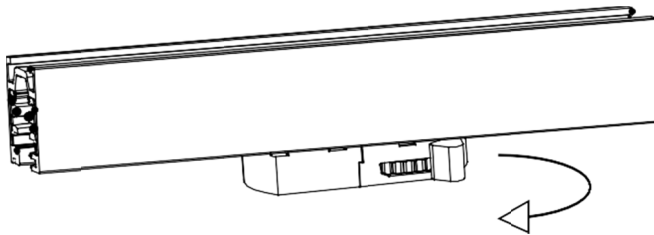

Note: Removing the rail light connector is the opposite of installing the rail light connector.

2. Brightness adjustment (please refer to the wireless dimming instructions for this item):

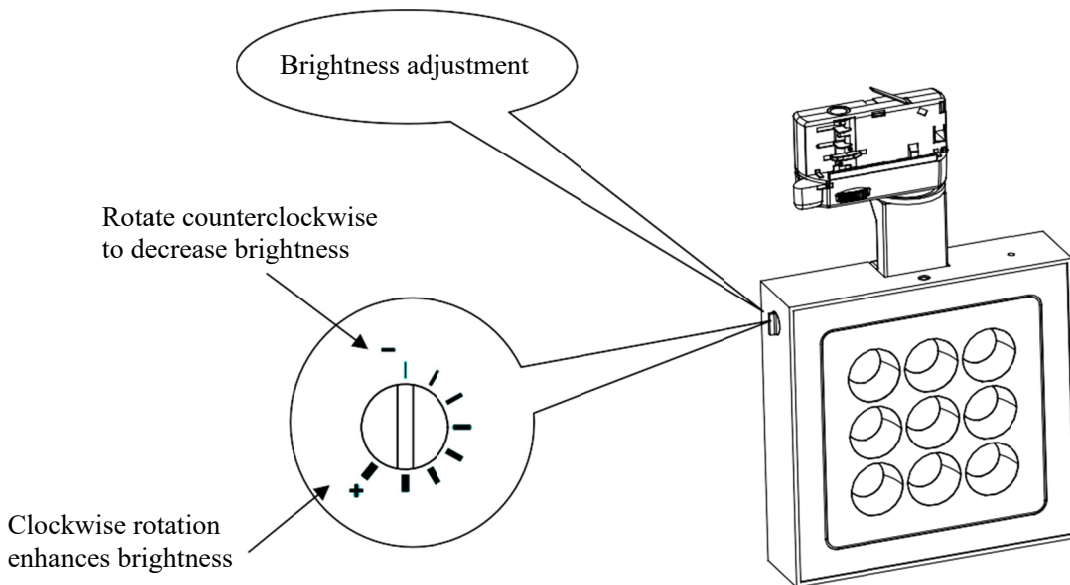

3. Lamp adjustment:

1) After the installation of the lamp, the lamp body can rotate vertically by 90 ° and horizontally by 355 °.

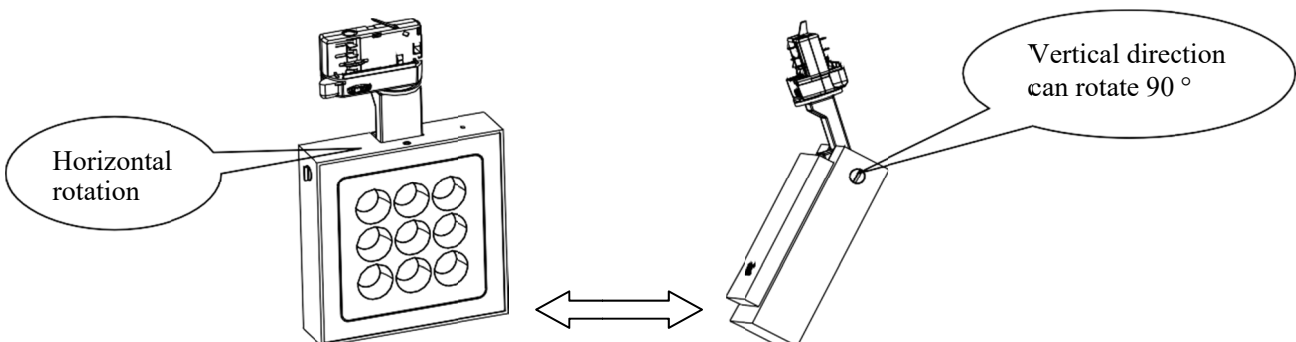

4. Installation of accessories:

- 1) Rotate the lamp body downwards to the appropriate position, align it with the notch of the front cover with a small flat screwdriver, pry open the front cover, and then pull it out by hand.
- 2) Remove the glass or diffusion film and replace it with the selected optical accessory or film.

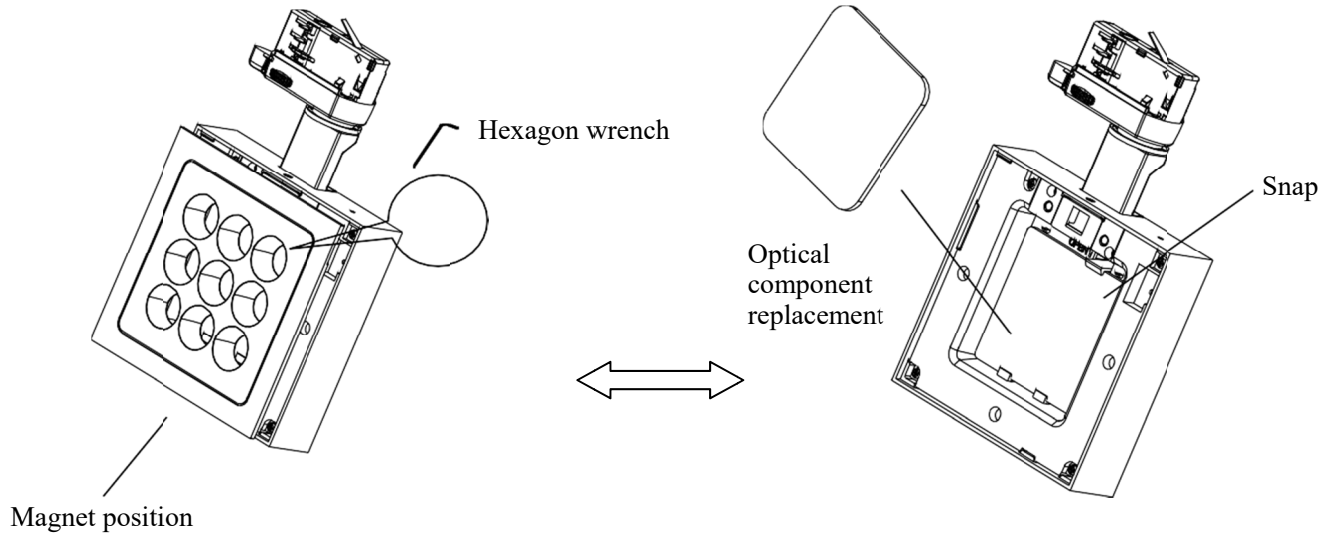

- 3) The installation sequence is opposite to the removal sequence. Install the surface cover according to the corresponding buckle direction. If you hear a "click" sound and there is no protrusion on the lamp surface cover, it is considered to be installed.

5. Maximum lifting weight:

- 1) The track system can withstand the maximum weight as shown in the following figure, which includes the weight of the entire suspension system.
- 2) A single adapter can withstand a maximum load of 10kg (apply the load to the adapter according to the normal installation position of the lamp).

