

## Installation Declaration:

1. Please read the instructions carefully before installation, please ask professional electricians to install.
2. In order to avoid the risk of electric shock, please confirm the power off before installation and maintenance;
3. The installation of lamps shall comply with the corresponding local laws and regulations, and the manual shall be retained for reference;
4. Waterproof lamps, wiring do waterproof treatment;
5. Do not install the lamp on the unstable and unstable skylight to avoid the lamp falling.

## Luminaire installation

1. Confirm that the ceiling is firm enough to support the weight of the lamp;
2. Drill holes in the ceiling and fix the mounting brackets (Figure 2,3,4);
3. As shown in the following figure, connect and install the lamps according to the requirements of the figure (5,6,7)

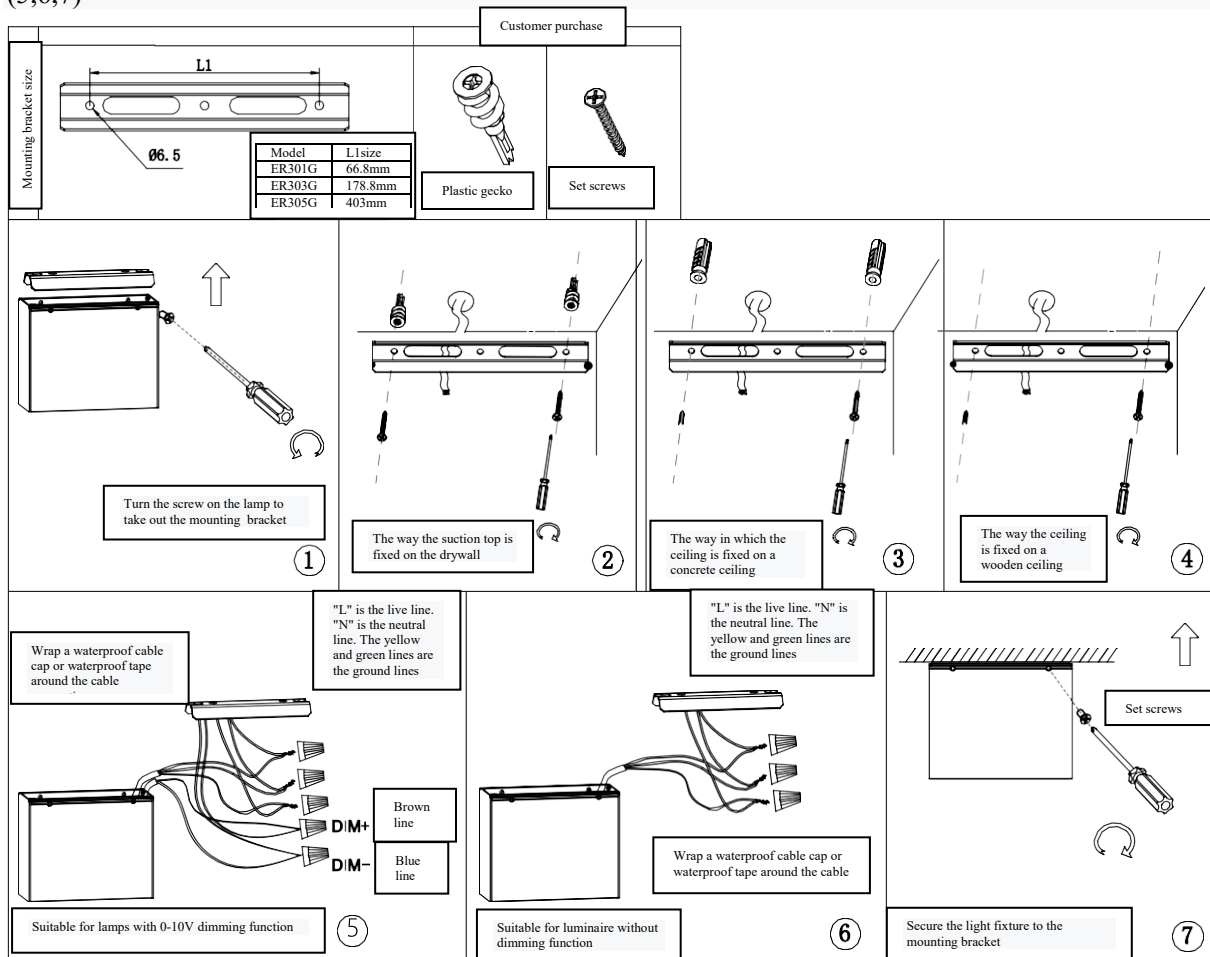

## Matters needing attention

1. the cable is not attached, the waterproof 3-core cable should be used, the diameter of the cable is  $\phi 5-\phi 9\text{mm}$  (the mark on the connector: Firewire L, neutral wire N, ground wire);
2. If the glass protective cover is found damaged during installation, it must be replaced;
3. Do waterproof treatment at the wiring.