

LEDME - MODEL: WL200

Step And Wall Luminaires

WAC

PROJECT: TYPE:

Product Image



Line Drawing

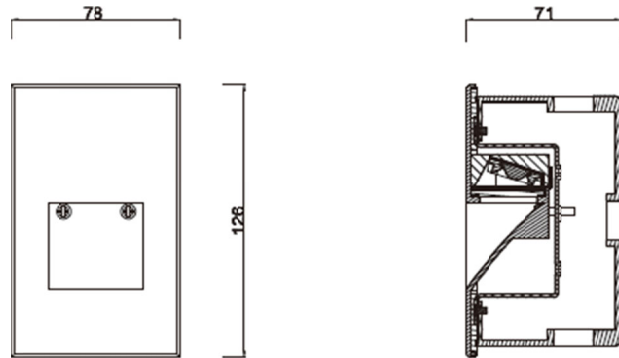

Product Description

Designed to accentuate the aesthetics of the building, the LEDme® luminaires are designed to blend seamlessly into the wall. Efficient energy savings and optimized light output increase the safety and style of the staircase, maintaining minimal glare on the walls and walkways. IP66 enables both indoor and outdoor lighting solutions in wet locations. 220V/ AC direct wiring is available.

Product Features

- Body Material: Aluminum alloy die-casting
- Optical System: /
- Finish: Static electricity powder coating
- Adjustable Angle: /
- Accessories: /
- Certification: CCC/CE
- IP Rating: IP66
- Insulation Level: Class I
- Operating Temperature: -20°C~50°C

Product Specifications

- Cut-out: 74*118mm
- LED Type: SMD
- LED Power: 3.22W
- Source Lm: 2700K 180LM/3000K 190LM/4000K 200LM;
- LED Lifetime: >40000h-L70 / B10-Ta25°C(LM-80 / TM-21)
- CCT/CRI: 2700K,Ra80; 3000K,Ra80; 4000K,Ra80
- SDCM: 3 SDCM
- Input: 220V/AC, 50 / 60Hz
- Dimming: On-off
- Net Weight: 0.48Kg without packing

Order Model

Model	Power(W)	Max Lumens(Lm)	Control Systems	CCT	Finish
WL200	LD05 3.2W	68	E ON-OFF 220V/AC Power Supply	27 2700K 30 3000K 40 4000K	WT White Coat BK Black Coat BZ Bronze BN Brushed Nickel

Example: WL200-LD05E-30WT

LEDME - MODEL: WL200

Step And Wall Luminaires

WAC

PROJECT:

TYPE:

Accessories

LIGHT DISTRIBUTION@3000K LUMINAIRE DATA

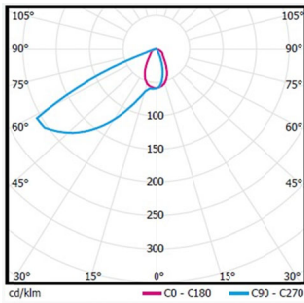

MODEL:	WL200-LD05E-30WT
BEAM ANGLE:	/
POWER:	3.1W
LUMENS:	48lm
CBCP:	/
EFFICACY:	15.5lm/W